

DC 高效塑料叶轮后倾离心风机
DC High-efficiency Backward Curved Centrifugal Fan

ErP2015
EXCEEDS THE NORM



Φ 220

转子材质 Rotor Material: 碳钢 Carbon steel
 叶轮材质 Impeller Material: 塑料 Plastic
 防护等级 Ingress Protection: IP42
 绝缘等级 Insulation Class: F
 轴承类型 Bearing Type: 免维护滚珠轴承
 Maintenance free ball bearing

性能曲线 Performance Curves

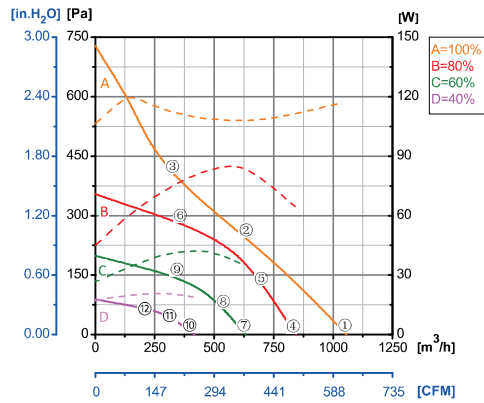

测试节点 Test Point	转速 Speed rpm	输入功率 Input Power W
1	2950	118
2	2554	107
3	2730	112
4	2361	64
5	2363	78
6	2361	79
7	1770	34
8	1771	39
9	1770	42
10	1178	19
11	1179	20
12	1178	20

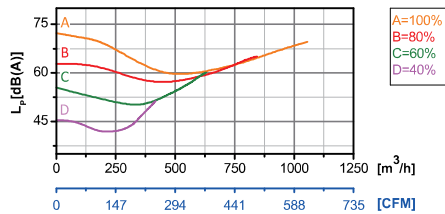

Erp2015 Data:
 Efficiency $\eta_{statA} = \% < 125W$
 Efficiency grade $N_{actual} = , N_{target} = 62$
 Test report NO. : L-20210302-005-108

产品型号 Model No.	电压 Voltage	频率 Frequency	转速 Speed	输入功率 Input Power	电流 Current	运行温度 Working Temp.	认证 Approvals
	VDC	Hz	RPM	W	A	Min/Max (°C)	
DC72-B220-A01	24	/	3000	120	5.00	-20/+60	CE
DC72-B220-C01	48	/	3000	120	2.50	-20/+60	CCC,CE
DC72-B220-D10	310	/	3000	120	0.39	-20/+60	CCC,CE

后倾离心风机 Motorized Backward Curved Impeller (24V&48V)

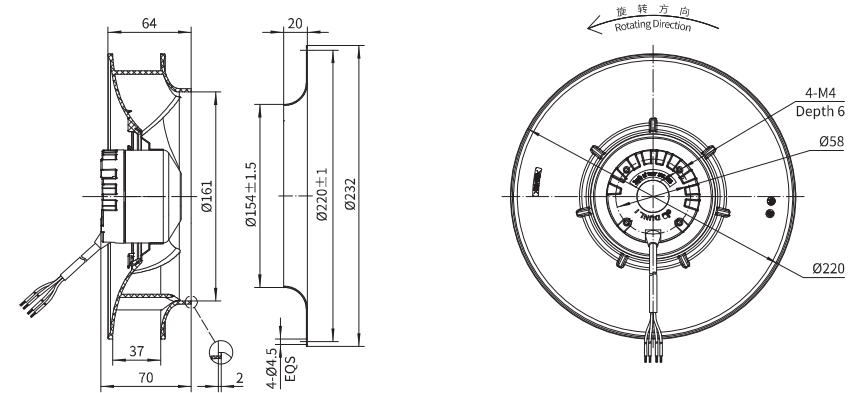

后倾离心风机 Motorized Backward Curved Impeller (310V)

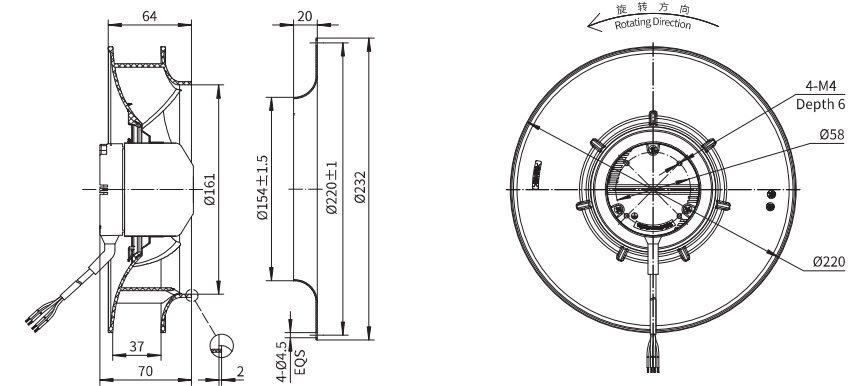

高效塑料叶轮后倾离心
High-efficiency B/C Centrifugal